

WOMSW180
WOMSW1100
WOMSW380
WOMSW3100

WOLVERINE Main Switch Series

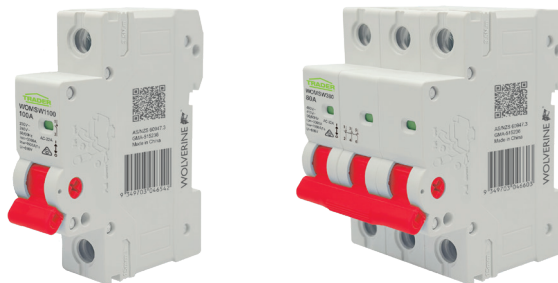

Overview:

Wolverine Din Rail mounted Main Switch Isolators (WOMSW series) offer fast and flexible installation and is suitable for residential and light commercial applications. Offering reliable performance for board configurations suited up to 100A and utilizing red switch toggles for easy identification along with the green/red indication of internal contact positions.

Perfect for applications where isolation is required either in the main or in local sub boards the WOMSW are only switches and do not operate to provide additional circuit protection, other models in Wolverine range offer this application.

Specifications

Electrical Features	Rated Operational Current Ie	80A, 100A
	Rated Uninterrupted Current Iu	80A, 100A
	Conventional Free Air Thermal Current Ith	80A, 100A
	Rated Operational Voltage Ue	230 Or 240V~(1P), 400 Or 415V~(3P)
	Number of Poles	1P or 3P
	Type Of Current	AC
	Rated Insulation Voltage Ui	690V
	Utilization Category	AC-22A
	Rated Short-Time Withstand Current Icw	1500A/1s
	Rated Short-Time Making Capacity	3000A
	Rated Frequency	50/60Hz
	Rated Impulse Withstand Voltage Uimp	6kV
	Rated Duty	Uninterrupted
Mechanical Features	Standard	AS 60947-3:2018
	Approval certificate number	GMA-515236
	Pollution Degree	3
	Ambient Temperature	-50c Degrees To +40oc
	Protection Degree	IP20
	Humidity	Should Not Exceed 50% At 40oc
	Method Of Operation	Independent Manual Operation
Installation	Terminal Size Top/Bottom For Busbar	50mm ² Max
	Terminal Size Top/Bottom For Cable	25mm ²
	Maximum Tightening Torque	3.5 N*m
	Recommended tightening torque for terminals	1.5 N*m
	Number Of Positions of The Main Contacts	2
	Module width	18 & 54
	Connection	From top or bottom are available
	Switching Type	Suitable For Isolation

Standard Number:

AS 60947.3

Certification Number:

GMA-515236

GSM Electrical (Australia) Pty Ltd

Level 2, 142-144 Fullarton Road, Rose Park SA 5067

P: 1300 301 838 F: 1300 301 778 E: service@gsme.com.au

www.gsme.com.au



Data Specification Sheet
June 2023

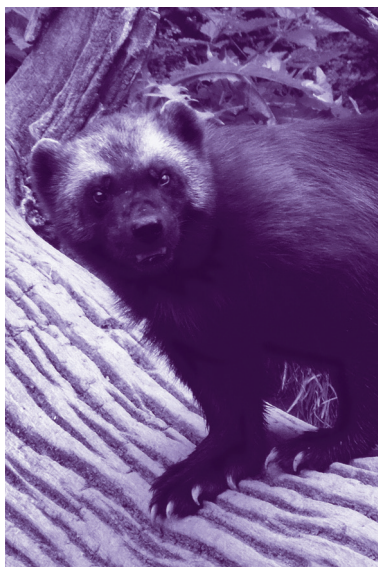

WOMSW180
WOMSW1100
WOMSW380
WOMSW3100

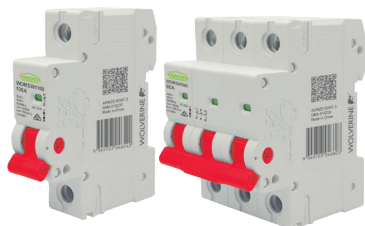

WOLVERINE Main Switch Series

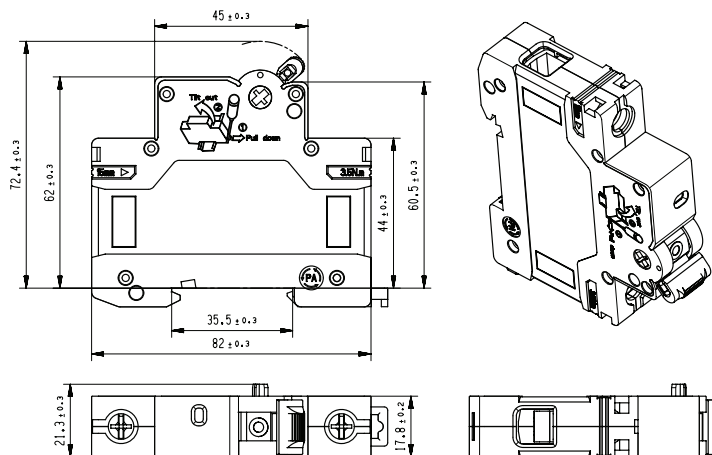

Installation Instruction



This product **MUST** be installed by a licensed electrician.

Line and Load can be top or bottom.

To avoid damage to Main Switch disconnect before insulation testing Connect the Neutral cable before the Line active cable.

- Used in domestic installations, as well commercial electrical distribution systems.

Wiring

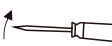
	
	L: 15mm S:(1.25)mm ²
	Recommended 1.5Nm

Status Indication

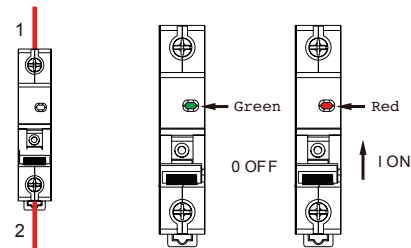

Mounting

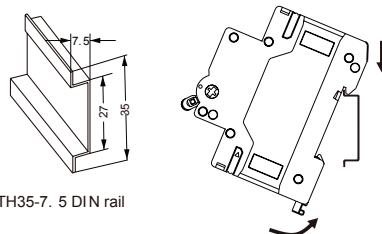

TH35-7. 5 DIN rail

Dismounting

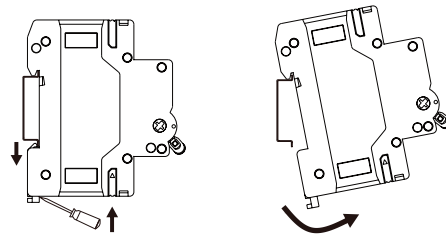

Page 2 of 2



Catalogue Number	Description
WOMSW180	Main Switch 1 Pole 80A 230V 240V 1 Module
WOMSW1100	Main Switch 1 Pole 100A 230V 240V 1 Module
WOMSW380	Main Switch 3 Pole 80A 400V 415V 3 Module
WOMSW3100	Main Switch 3 Pole 100A 400V 415V 3 Module

Standard Number:

AS 60947.3

Certification Number:

GMA-515236

GSM Electrical (Australia) Pty Ltd

Level 2, 142-144 Fullarton Road, Rose Park SA 5067

P: 1300 301 838 F: 1300 301 778 E: service@gsme.com.au

www.gsme.com.au



Data Specification Sheet
June 2023

WORCD6240
WORCD6263
WORCD6440
WORCD6463

Wolverine Type A RCD Series

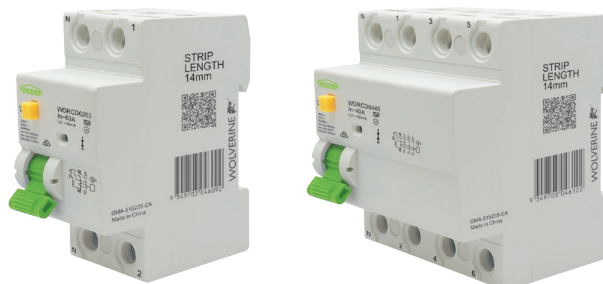

Overview:

Wolverine Din Rail mounted RCDs (WORCD series) offer fast and flexible installation for safety of personal and equipment protection applications in domestic and small commercial environments. Being fully certified in accordance with standard AS/NZS and IEC 61008-1 (Residual current circuit breakers for household and similar purposes). Providing protection against earth faults that may occur in equipment and reduce the effects of electric shock and save lives by cutting off supply if they have measured an imbalance between the live and neutral cables above the sensitivity level where current flowing in the live and neutral cables becomes imbalanced from current flowing to earth.

They feature easy-to-use terminals, din assembly and U-style busbar suitability. The Wolverine RCDs are available in type A sensing characteristic and ideal for applications for protection of general everyday use and available in 30mA operating current. Type A RCDs are sensitive to both sinusoidal currents and "unidirectional pulsed" currents, which may be present in modern electrical systems with electronic devices for rectifying the current or similar equipment. They are ideal for protection in applications for electronic components, inverters, class 1 IT & multimedia equipment, power supplies for class 2 equipment, lighting controls, induction hobs and washing machines.

Page 1 of 3



Catalogue Number	Description
WORCD6240	RCD Residual Current Device 6kA 2 Pole 40 Amp 230 240V 30mA Type A 2 Module
WORCD6263	RCD Residual Current Device 6kA 2 Pole 63 Amp 230 240V 30mA Type A 2 Module
WORCD6440	RCD Residual Current Device 6kA 4 Pole 40 Amp 400 415V 30mA Type A 4 Module
WORCD6463	RCD Residual Current Device 6kA 4 Pole 63 Amp 400 415V 30mA Type A 4 Module

Standard Number:

AS/NZS_61008.1

Certification Number:

GMA-515235-EA

GSM Electrical (Australia) Pty Ltd

Level 2, 142-144 Fullarton Road, Rose Park SA 5067

P: 1300 301 838 F: 1300 301 778 E: service@gsme.com.au

www.gsme.com.au



Data Specification Sheet
June 2023

WORCD6240
WORCD6263
WORCD6440
WORCD6463

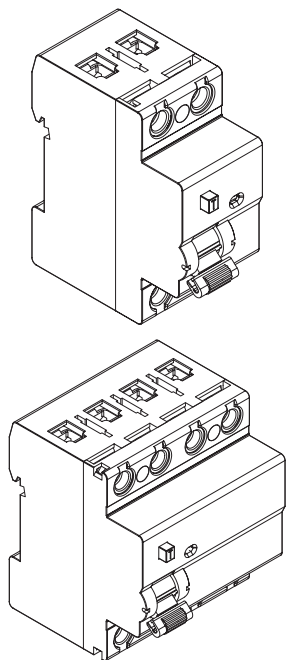

Wolverine Type A RCD Series



Electrical Features	Type	Electro-magnetic
	Current Rating	40A,63A
	Rated Voltage	230/240V,400/415V
	Pole Number	1P+N,3P+N
	Type (wave form of the earth leakage)	Type A
	Breaking Capacity	6kA
	Rated Frequency	50/60Hz
	Rated Sensitivity I _n	30mA only available
	Rated Impulse Withstand Voltage U _{imp}	4000V
	Rated making and breaking capacity	400A,630A
	Terminal Connection Height	19mm
	Pollution Degree	2
	Standard	AS/NZS 61008.1
	Approval certificate number	GMA-515235-EA
Mechanical Features	Protection Degree	IP20
	Electro-mechanical endurance	4,000 cycles
	Contact Position Indicator	Yes
	Ambient Temperature	-25~+40
Installation	Terminal Connection Type	Cable/U-type busbar/Pin-type busbar
	Terminal Size Top/Bottom For Cable	25mm ²
	Maximum Tightening Torque	3.5 Nm
	Recommended tightening torque for terminals	1.5 Nm
	Mounting	On DIN rail EN 60715 (35mm) by means of fast clip device
	Connection	Terminal Screw terminal, Pillar terminal with clamp
	Application	Residential and Light Commercial

Page 2 of 3

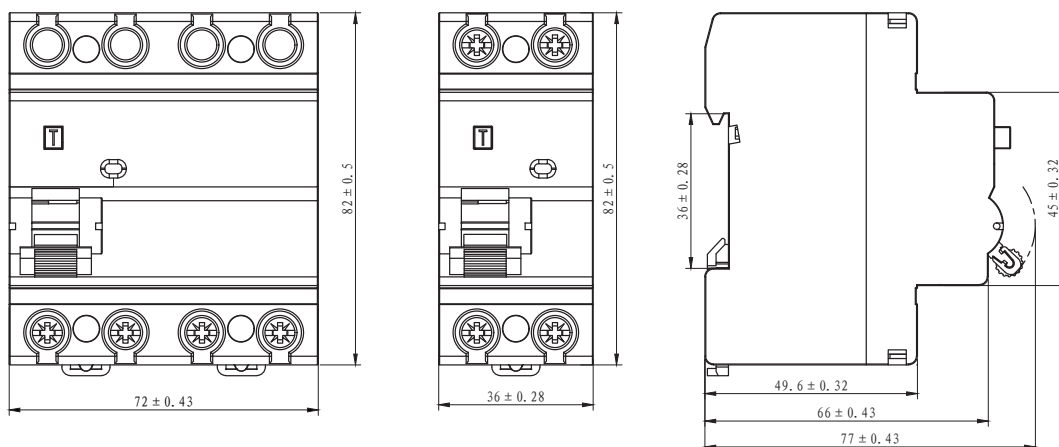

Standard Number:

AS/NZS_61008.1

Certification Number:

GMA-515235-EA

GSM Electrical (Australia) Pty Ltd

Level 2, 142-144 Fullarton Road, Rose Park SA 5067

P: 1300 301 838 F: 1300 301 778 E: service@gsme.com.au

www.gsme.com.au



Data Specification Sheet
June 2023

WORCD6240
WORCD6263
WORCD6440
WORCD6463

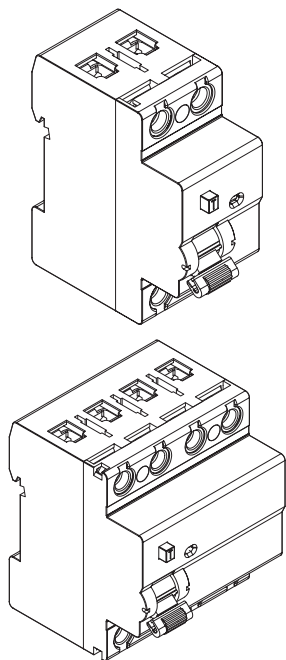

Wolverine Type A RCD Series



Installation Instruction

This product **MUST** be installed by a licensed electrician.

Line and Load can be top or bottom.

To avoid damage to RCD disconnect before insulation testing Connect the Neutral cable before the Line active cable.

- Used in domestic installations, as well commercial electrical distribution systems.
- Protection of circuits against short-circuit currents.
- Protection of circuits against overload currents.

Wiring

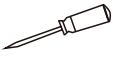
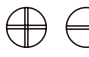
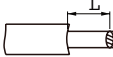
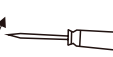
	
	L: 14mm S: (1-25)mm ²
	Recommended 1.5Nm

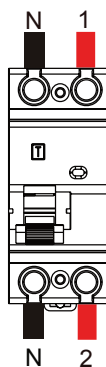

Status Indication

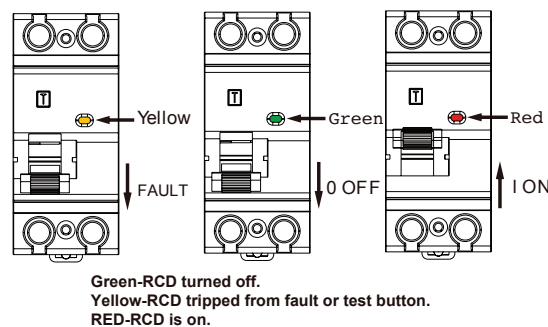

Mounting

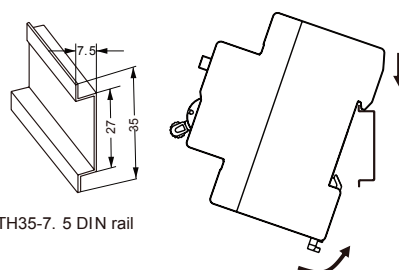

Dismounting

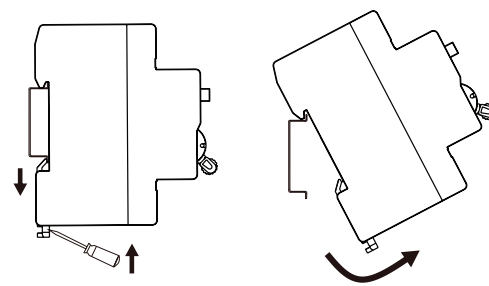

Page 3 of 3

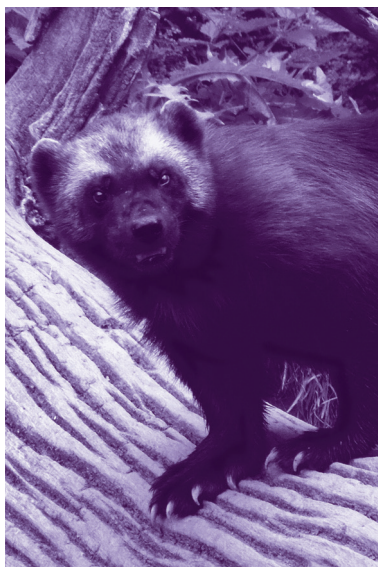

WARNING: If RCD trips it maybe caused by either, overload, short circuit or earth leakage. The installation should be checked before resetting RCD.

Standard Number:

AS/NZS_61008.1

Certification Number:

GMA-515235-EA

GSM Electrical (Australia) Pty Ltd

Level 2, 142-144 Fullarton Road, Rose Park SA 5067

P: 1300 301 838 F: 1300 301 778 E: service@gsme.com.au

www.gsme.com.au



Data Specification Sheet
June 2023

WOMCB6110
WOMCB6116
WOMCB6120
WOMCB6125
WOMCB6132
WOMCB6163
WOMCB6163R
WOMCB6310
WOMCB6316
WOMCB6320
WOMCB6325
WOMCB6332
WOMCB6363
WOMCB6363R

Page 1 of 3

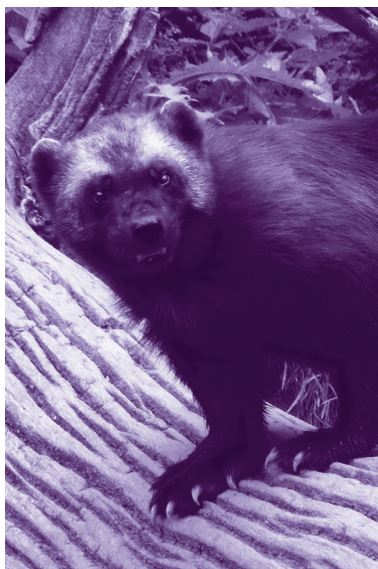

WOLVERINE MCB Series



Overview:

Wolverine Miniature Circuit Breakers (WOMCB series) offer fast and flexible installation and safety for circuit protection applications in domestic and commercial environments. Being fully certified in accordance with standard AS/NZS and IEC 60898-1 for the application for household installations and for similar purposes.

They provide fast and flexible installation with easy-to-use terminals, din assembly and U-style busbar suitability. The Wolverine MCBs are available in C curve tripping characteristic and ideal for applications for the protection of resistive and inductive loads with low inrush current is suitable for protecting distribution lines, lighting lines and motor circuits with high connecting currents, equipment in office and residential buildings.

63Amp models marked with the R in the catalogue number have been configured for MCB/Main Switch applications and are available in 1 pole and 3 pole.

Catalogue Number	Description
WOMCB6110	MCB Miniature Circuit Breaker 6kA 1 Pole 10 Amp C Curve 230V 240V ac 1 Module
WOMCB6116	MCB Miniature Circuit Breaker 6kA 1 Pole 16 Amp C Curve 230V 240V ac 1 Module
WOMCB6120	MCB Miniature Circuit Breaker 6kA 1 Pole 20 Amp C Curve 230V 240V ac 1 Module
WOMCB6125	MCB Miniature Circuit Breaker 6kA 1 Pole 25 Amp C Curve 230V 240V ac 1 Module
WOMCB6132	MCB Miniature Circuit Breaker 6kA 1 Pole 32 Amp C Curve 230V 240V ac 1 Module
WOMCB6163	MCB Miniature Circuit Breaker 6kA 1 Pole 63 Amp C Curve 230V 240V ac 1 Module
WOMCB6163R	MCB Miniature Circuit Breaker 6kA 1 Pole 63 Amp C Curve 230V 240V ac 1 Module Main Switch Suitable
WOMCB6310	MCB Miniature Circuit Breaker 6kA 3 Pole 10 Amp C Curve 400V 415V ac 3 Module
WOMCB6316	MCB Miniature Circuit Breaker 6kA 3 Pole 16 Amp C Curve 400V 415V ac 3 Module
WOMCB6320	MCB Miniature Circuit Breaker 6kA 3 Pole 20 Amp C Curve 400V 415V ac 3 Module
WOMCB6325	MCB Miniature Circuit Breaker 6kA 3 Pole 25 Amp C Curve 400V 415V ac 3 Module
WOMCB6332	MCB Miniature Circuit Breaker 6kA 3 Pole 32 Amp C Curve 400V 415V ac 3 Module
WOMCB6363	MCB Miniature Circuit Breaker 6kA 3 Pole 63 Amp C Curve 400V 415V ac 3 Module
WOMCB6363R	MCB Miniature Circuit Breaker 6kA 3 Pole 63 Amp C Curve 400V 415V ac 3 Module Main Switch Suitable

Standard Number:

AS/NZS 60898.1

Certification Number:

GMA-515234-EA

GSM Electrical (Australia) Pty Ltd

Level 2, 142-144 Fullarton Road, Rose Park SA 5067

P: 1300 301 838 F: 1300 301 778 E: service@gsme.com.au

www.gsme.com.au



Data Specification Sheet
June 2023

WOMCB6110
WOMCB6116
WOMCB6120
WOMCB6125
WOMCB6132
WOMCB6163
WOMCB6163R
WOMCB6310
WOMCB6316
WOMCB6320
WOMCB6325
WOMCB6332
WOMCB6363
WOMCB6363R

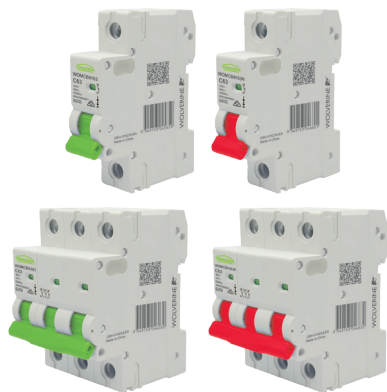

Page 2 of 3

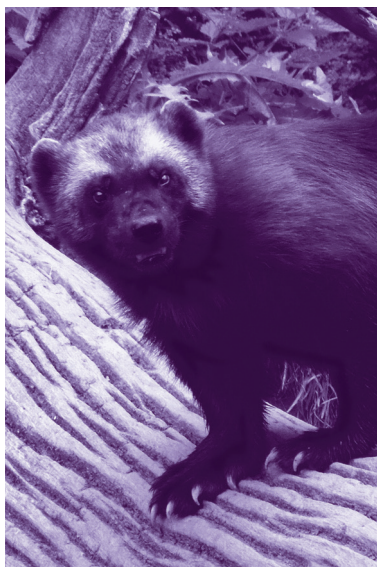

WOLVERINE MCB Series

Electrical Features	Rated current	10A, 16A, 20A, 25A, 32A, 63A
	Rated Operational Voltage	230V 240V ~ (1P), 400V 415V ~ (3P)
	Number of Poles	1P or 3P
	Type Of Current	AC ONLY
	Thermo- Magnetic Release Characteristic	C Curve
	Breaking capacity	6kA
	Rated Insulation Voltage	500V
	Rated Impulse Withstand Voltage	4kV
	Standard	AS/NZS 60898-1
	Approval certificate number	GMA-515234-EA
Mechanical Features	Energy Limiting Class 3	6000J3
	Use Ambient Temperature Range	30 to +70 Celcius
	Protection Degree	IP20
	Humidity	+25°C≤95%
Installation	Terminal Size Top/Bottom For Cable	25mm ²
	Maximum Tightening Torque	2.5 Nm
	Recommended tightening torque for terminals	1.5 Nm
	Number Of Positions of The Main Contacts	2
	Module width	18 & 54
	Connection	From top or bottom are available
	Application	Short-circuit & Overload
	Contact Indicator	Green=off, Red=ON
	Current Range	Up to 63A
	Mounting	On DIN rail EN 60715 (35mm) by means of fast clip device
	Terminal Connection	Cable/U-Type Busbar/Pin-Type Busbar
	Handle Lockable	In On/Off Position

Applications:

- Used in domestic installations, as well commercial electrical distribution systems.
- Protection of circuits against short-circuit currents Protection of circuits against overload currents.
- Isolation Switch suitability (variants with red toggles denoted with R at the end).

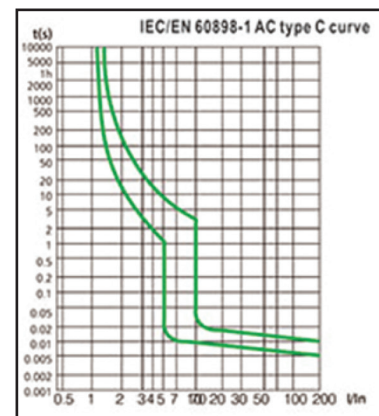
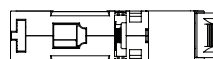
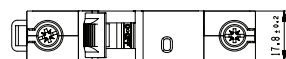
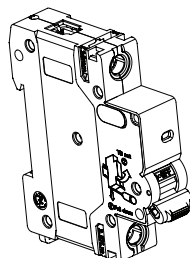
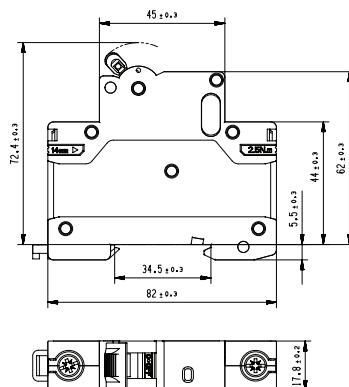

Standard Number:

AS/NZS 60898.1

Certification Number:

GMA-515234-EA

GSM Electrical (Australia) Pty Ltd

Level 2, 142-144 Fullarton Road, Rose Park SA 5067

P: 1300 301 838 F: 1300 301 778 E: service@gsme.com.au

www.gsme.com.au



Data Specification Sheet
June 2023

WOMCB6110
WOMCB6116
WOMCB6120
WOMCB6125
WOMCB6132
WOMCB6163
WOMCB6163R
WOMCB6310
WOMCB6316
WOMCB6320
WOMCB6325
WOMCB6332
WOMCB6363
WOMCB6363R

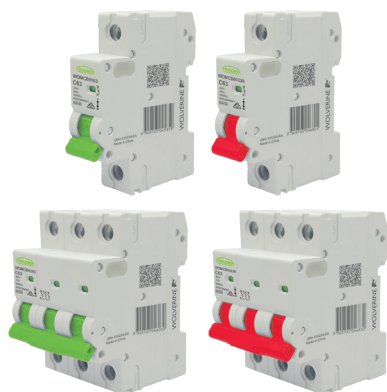

Page 3 of 3



WOLVERINE MCB Series

Installation Instruction

This product **MUST** be installed by a licensed electrician.
Line and Load can be top or bottom.
To avoid damage to MCB disconnect before insulation testing
Connect the Neutral cable before the Line active cable.

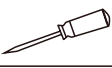
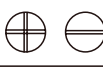
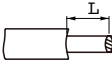
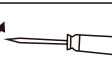
	
	L: 14mm S: (1-25)mm ²
	Recommended 1.5Nm

Applications:

- Used in domestic installations, as well commercial electrical distribution systems
- Protection of circuits against short-circuit currents
- Protection of circuits against overload currents
- Solation Switch suitability (variants with red toggles denoted with R at the end)

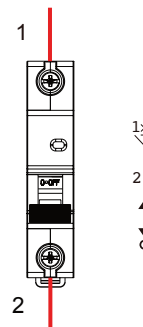

Mounting

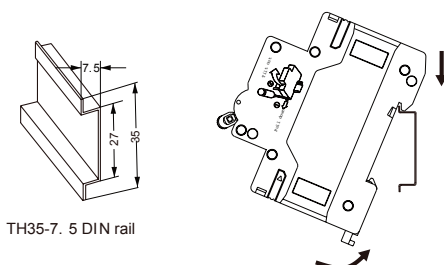

Dismounting

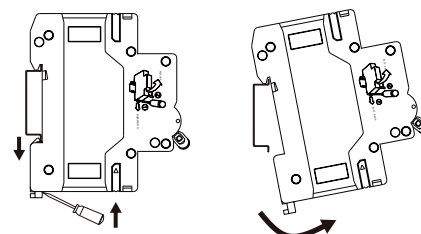

Status Indication

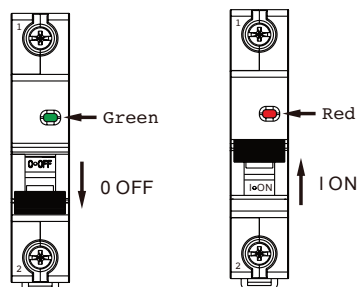

WARNING: If MCB trips it maybe caused by either, overload, short circuit or earth leakage.
The installation should be checked before resetting MCB.

Standard Number:

AS/NZS 60898.1

Certification Number:

GMA-515234-EA

GSM Electrical (Australia) Pty Ltd

Level 2, 142-144 Fullarton Road, Rose Park SA 5067

P: 1300 301 838 F: 1300 301 778 E: service@gsme.com.au

www.gsme.com.au



Data Specification Sheet
June 2023

WORCBO45110
WORCBO45116
WORCBO45120
WORCBO45125
WORCBO45132
WORCBO6110
WORCBO6116
WORCBO6120
WORCBO6125
WORCBO6132

WOLVERINE RCBO SERIES

TYPE A RCBO 4.5kA and 6kA



Overview:

Wolverine Din Rail mounted RCBOs (WORCBO series) offer fast and flexible installation for safety of personal and equipment protection applications in domestic and small commercial environments as well as circuit protection up to 6kA. Being fully certified in accordance with standard AS/NZS 61009-1 and IEC 61009-1 (Residual current circuit breakers for household and similar purposes). Providing protection against short circuit, overcurrent situations and earth faults that may occur in equipment as well as reduce the effects of electric shock and save lives by cutting off supply if they have measured an imbalance between the live and neutral cables above the sensitivity level where current flowing in the live and neutral cables becomes imbalanced from current flowing to earth.

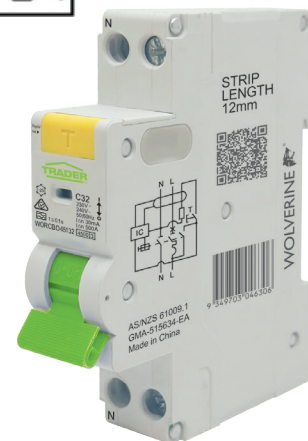

They provide fast and flexible installation with easy-to-use terminals, din assembly and tongue style busbar suitability. The Wolverine RCBO's are available in C curve tripping characteristic and ideal for applications for protection of resistive and inductive loads with low inrush current is suitable for protecting distribution lines, lighting lines and motor circuits with high connecting current, equipment in office and residential buildings. Available in single module with non-directional orientation input (either input Line/Neutral from top terminals or from the bottom) for easy flexible installations.

The Wolverine RCBOs are available in type A sensing characteristic only and ideal for applications for protection of general everyday use and available in 30mA operating current. Type A RCBO's are sensitive to both sinusoidal currents and "unidirectional pulsed" currents, which may be present in modern electrical systems with electronic devices for rectifying the current or similar equipment.

They are ideal for protection in applications for electronic components, inverters, class 1 IT & multimedia equipment, power supplies for class 2 equipment, lighting controls, induction hobs and washing machines.

Features:

- Earth leakage protection
- Overload and short circuit protection
- Non-Line / Load sensitive allows the electricians to either "input from the top and output from the bottom" or "input from the bottom and output from the top" without issue and this provides greater versatility and ease of installation
- Compact SLIM module design, allows for more RCDs/MCBs to be installed in the one enclosure
- True Double Pole Disconnection in a Single Module RCBO
- Double pole switching for complete isolation of faulty circuits
- Neutral pole switching significantly reduces the installation and insulated openings for easy busbar installations
- Compatible with multiple types of screwdrivers with combination head screws
- Meets ESV Additional Testing & verification requirements for RCBOs
- Complies with AS/NZS 61009-1

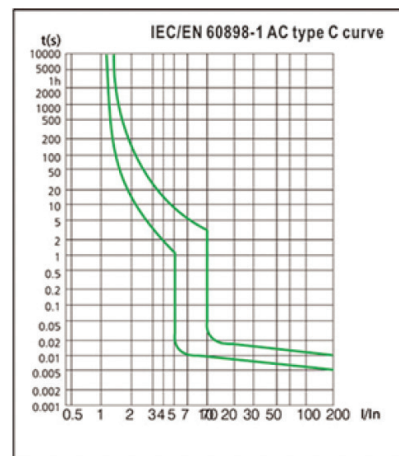

Page 1 of 3

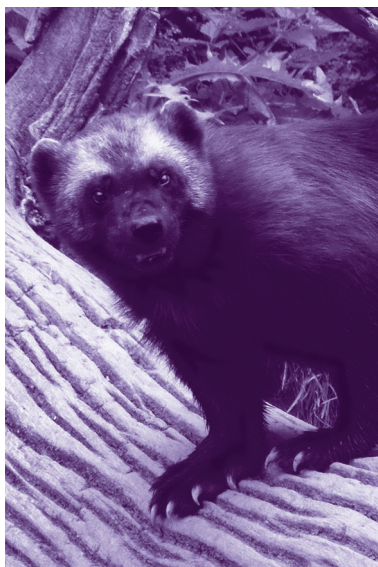

Standard Number:

AS/NZS 61009-1

Certification Number:

GMA-515235-EA

GSM Electrical (Australia) Pty Ltd

Level 2, 142-144 Fullarton Road, Rose Park SA 5067

P: 1300 301 838 F: 1300 301 778 E: service@gsme.com.au

www.gsme.com.au



Data Specification Sheet
June 2023

WORCBO45110
WORCBO45116
WORCBO45120
WORCBO45125
WORCBO45132
WORCBO6110
WORCBO6116
WORCBO6120
WORCBO6125
WORCBO6132

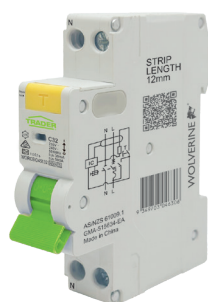

Page 2 of 3



WOLVERINE RCBO SERIES

TYPE A RCBO 4.5kA and 6kA



Specifications:

Electrical Features	Type	Electronic
	Current Rating	10A, 16A, 20A, 25A, 32A
	Rated Voltage	230V, 240V
	Number of Poles	1P+N
	Type (wave form of the earth leakage sensed)	A-Type
	Thermo- magnetic Release Characteristic	C curve
	Rated Sensitivity I _n	30mA
	Breaking Capacity	4.5kA, 6kA
	Rated Frequency	50/60Hz
	Rated impulse withstand voltage (Uimp)	4kV
	Standard	IEC 61009-1, AS/NZS61009.1
Mechanical Features	Pollution Degree	2
	Ambient Temperature	-21°C+40°C
	Protection Degree	IP20
	Electrical Life	2,000 times
	Mechanical Life	2,000 times
	Contact Position Indicator	Green=OFF, Red=ON
	Terminal Connection Type	Cable/Pin-type busbar
	Terminal Size Top/Bottom For Busbar	10mm ²
Installation	Grid distance up to and including 1500A	35mm
	Grid Distance above 1500A	100mm
	Terminal Size Top/Bottom For Cable	10mm ²
	Maximum Tightening Torque	2.0Nm
	Recommended tightening torque for terminals	1.5 Nm
	Mounting	On DIN rail EN 60715 (35mm) by means of fast clip device
	Connection	From top or bottom are available (bi directional)

Catalogue Number	Description
WORCBO45110	RCBO Residual Current Breaker with Overcurrent Protection 4.5kA 1 Pole 10A 230 240V 30mA Type A 1 Module
WORCBO45116	RCBO Residual Current Breaker with Overcurrent Protection 4.5kA 1 Pole 16A 230 240V 30mA Type A 1 Module
WORCBO45120	RCBO Residual Current Breaker with Overcurrent Protection 4.5kA 1 Pole 20A 230 240V 30mA Type A 1 Module
WORCBO45125	RCBO Residual Current Breaker with Overcurrent Protection 4.5kA 1 Pole 25A 230 240V 30mA Type A 1 Module
WORCBO45132	RCBO Residual Current Breaker with Overcurrent Protection 4.5kA 1 Pole 32A 230 240V 30mA Type A 1 Module
WORCBO6110	RCBO Residual Current Breaker with Overcurrent Protection 6kA 1 Pole 10A 230 240V 30mA Type A 1 Module
WORCBO6116	RCBO Residual Current Breaker with Overcurrent Protection 6kA 1 Pole 16A 230 240V 30mA Type A 1 Module
WORCBO6120	RCBO Residual Current Breaker with Overcurrent Protection 6kA 1 Pole 20A 230 240V 30mA Type A 1 Module
WORCBO6125	RCBO Residual Current Breaker with Overcurrent Protection 6kA 1 Pole 25A 230 240V 30mA Type A 1 Module
WORCBO6132	RCBO Residual Current Breaker with Overcurrent Protection 6kA 1 Pole 32A 230 240V 30mA Type A 1 Module

The product is listed on the Energy Safe Victoria website for approved RCBO usage in Victoria.

Standard Number:

AS/NZS 61009-1

Certification Number:

GMA-515235-EA

GSM Electrical (Australia) Pty Ltd

Level 2, 142-144 Fullarton Road, Rose Park SA 5067

P: 1300 301 838 F: 1300 301 778 E: service@gsme.com.au

www.gsme.com.au



Data Specification Sheet
June 2023

WORCBO45110
WORCBO45116
WORCBO45120
WORCBO45125
WORCBO45132
WORCBO6110
WORCBO6116
WORCBO6120
WORCBO6125
WORCBO6132

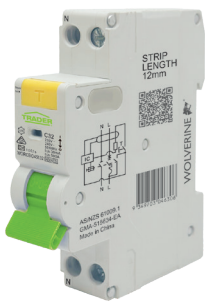

WOLVERINE RCBO SERIES TYPE A RCBO 4.5kA and 6kA





Installation Instruction

This product **MUST** be installed by a licensed electrician.

Line and Load can be top or bottom.

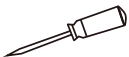
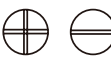
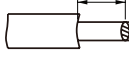
To avoid damage to RCD disconnect before insulation testing Connect the Neutral cable before the Line active cable.

	
	L: 12m m S: (1-10)mm ²
	Recommended 1.5Nm

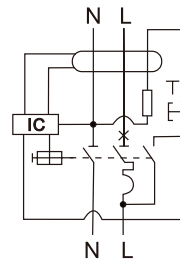
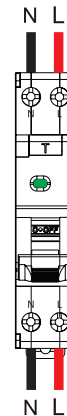

Applications:

- Used in domestic installations, as well commercial electrical distribution systems
- Protection of circuits against short-circuit currents
- Protection of circuits against overload currents

Mounting

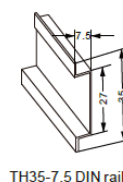

TH35-7.5 DIN rail

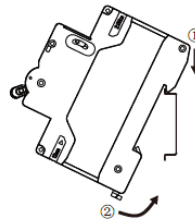

Dismounting

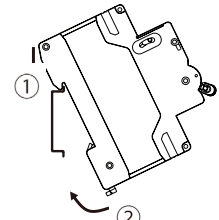
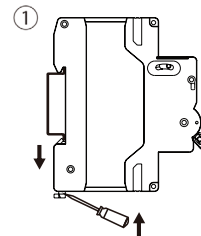

Status Indication

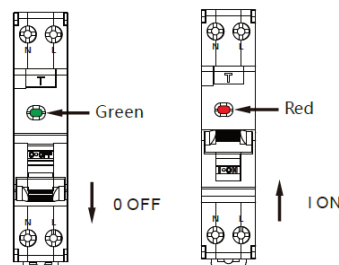

Page 3 of 3



Standard Number:

AS/NZS61009-1

Certification Number:

GMA-515235-EA

GSM Electrical (Australia) Pty Ltd

Level 2, 142-144 Fullarton Road, Rose Park SA 5067

P: 1300 301 838 F: 1300 301 778 E: service@gsme.com.au

www.gsme.com.au



Data Specification Sheet
June 2023

WONBPM7

Wolverine Neutral Bar Link Panel Mount

- 500V 110A 7 Hole Panel mountable Neutral Bar Link with two screws per tunnel.
- Black Insulated cover and base with large mounting apertures.
- Dimensions: 67.5 x 47 x 47mm. Mounting centres: 39mm with 12 x 5.5 mm slots.
- 4 tunnels, 6.3mm diameter accommodate 1 x 16mm² cable.
- 3 tunnels, 4.6mm diameter accommodate 1 x 10mm² cable.

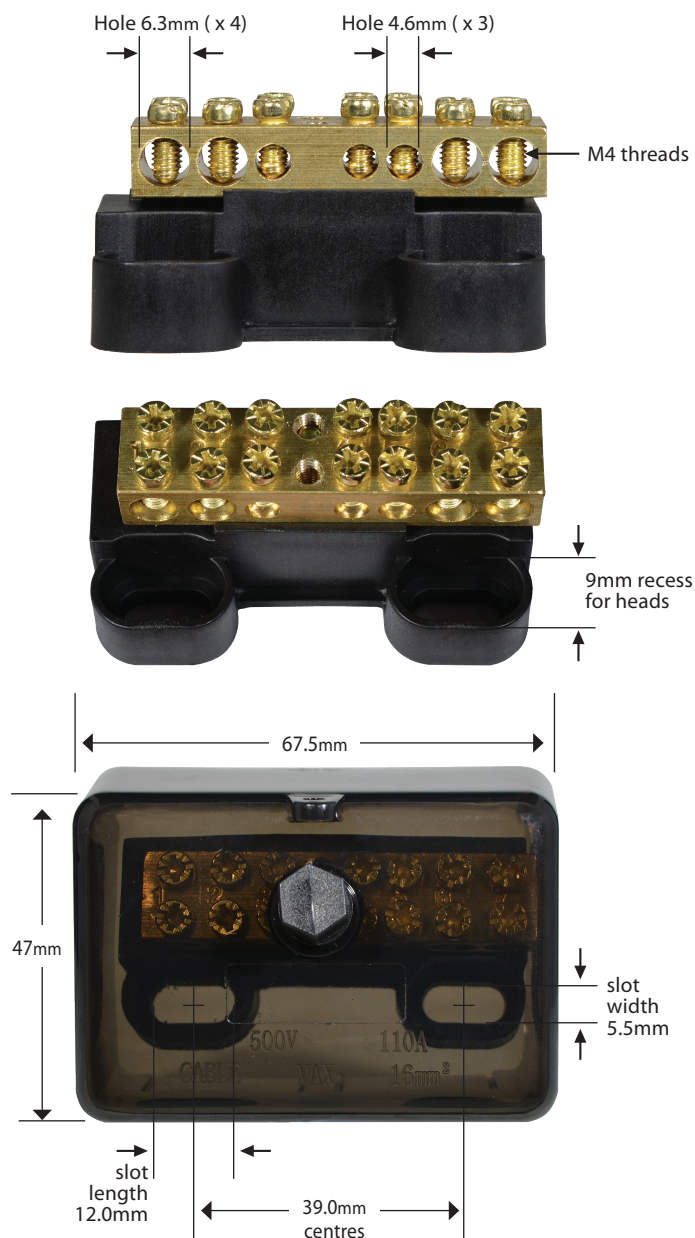

Catalogue Number	Description
WONBPM7	Neutral Bar Panel Mount 7 Hole With Insulating Cover

