

Catalogue No: TDGA2

ELR TOROID CLOSED CORE 2 WIRE 28mm min 30mA

Power Distribution and Protection > Earth Leakage Protection > Earth Leakage Relays > IME Earth Leakage Relays and Toroids > 2 Wire Toroid > TDG Series - Closed Core Toroid

Earth Leakage Toroid 2 wire to suit RD relay. 28mm internal diameter

- Suits RD Series Earth Leakage Relays
- Internal diameter 28-310 mm
- Closed core and split core models



Representative Photo Only
(actual product may vary based on configuration selections)

SPECIFICATIONS

Product Series	TD
Component Type Power Distribution & Protection	Toroid
Component Type Transformer	Closed-core Transformer
Details, Transformer	Suits RD range of earth leakage relays
Ie, Rated Operational Current, nom	65 A,nom
Ie, Rated Operational Current, max	390 A,max
IΔn, Leakage Current, Min	30 mA
Ith, Thermal Current, Short Time, 1s	20 kA
Idyn, Current, Dynamic	40kA/ 0.05s
Diameter, Internal	28 mm
Ui, Rated Insulation Voltage	720 V (rms)
Material, Body / Housing	ABS Self extinguishing material
Terminal Type	Screw Terminal(s)
Operating Temperature, Min	-10 °C min
Operating Temperature, Max	55 °C max
Storage Temperature, Min	-40 °C min
Storage Temperature, Max	70 °C max
Details, Primary Circuit	Supply conductors to be protected pass through toroid hole
Ie, Rated Operational Current, nom	65 A,nom
Humidity Type	Suitable for tropical environments
Standards Compliance	IEC 60755 IEC 60947-2 EN 60947-2
Sealable	Yes
Width	59 mm
Height	59 mm
Depth	47 mm
Weight	0.2 kg

Catalogue No: TDGA2

ELR TOROID CLOSED CORE 2 WIRE 28mm min 30mA

Power Distribution and Protection > Earth Leakage Protection > Earth Leakage Relays > IME Earth Leakage Relays and Toroids > 2 Wire Toroid > TDG Series - Closed Core Toroid



REFERENCES

IECEX Certificate -

Supplier Declaration of Conformity: -

Installation Guide: -

User Manual: -

Manufacturer Datasheet: -

Manufacturer Catalogue & Product Selection: -

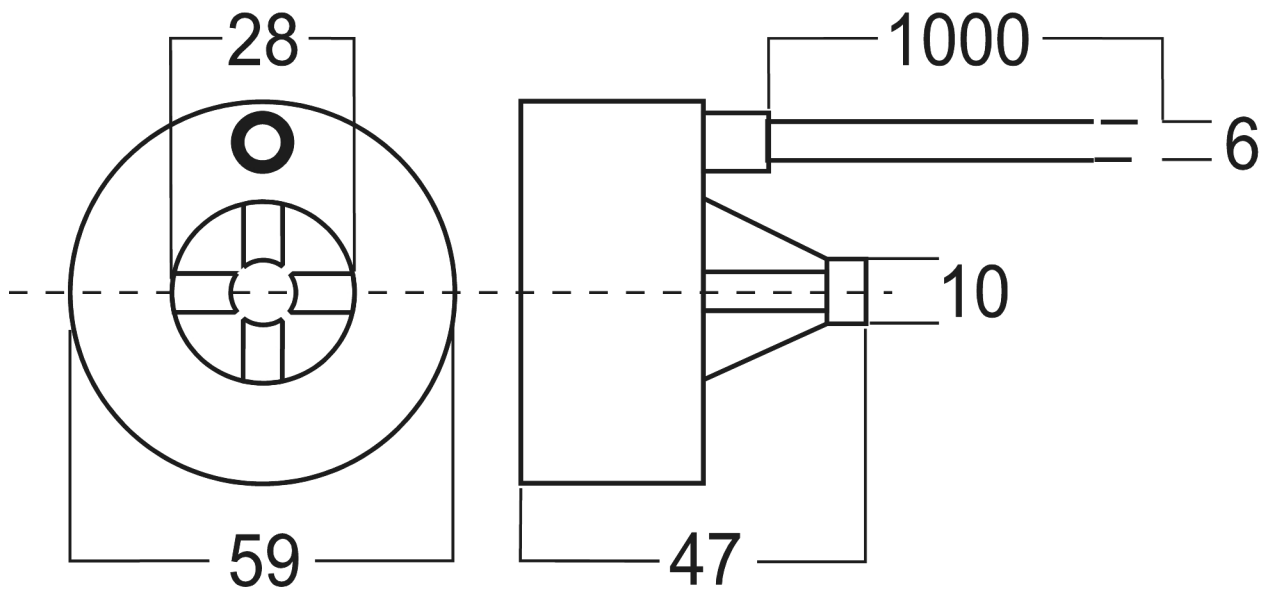

Weight 200g

Dimension Diagram