



PIXIE TIMER SWITCH STS350BT

SMART HOME digital push button timer switch from 1 minute to 24 hour

Application

Ideal for residential designs and commercial interior spaces requiring precise digital scheduling and energy saving opportunities

Design Specifications

- Digital push button control with three (3) complimentary key caps provided to suit most switch plates
- Easy to install, (1) minute to (24) hour programmable delay time
- Easy navigation and simple time delay selection when using the app.
- As a PIXIE MASTER device, functionality is achieved with all compatible loads (min 13W /max 350W), see installation sheet for details
- With the inclusion of the SAL Gateway and the internet, you can control your PIXIE devices from anywhere in the world
- Support override function and restart delay timer functions



Technical Specification

| Model No. | Input Voltage (V/AC) | Dim (mm) |
|-----------|----------------------|-------------------------|
| STS350BT | 240 | 40(L) x 24(W) x 37.5(H) |

Minimum load rating is subject to product capability, this size load may require the inclusion of the LOAD capacitor included in the product carton.

Due to continued product and technology enhancements, data sourced from sal.net.au shall not form part of any contract and or technical performance guarantee unless expressly confirmed in writing by SAL at the time of order. Products are sold in accordance with [SAL Terms and Conditions of sale](#) and all images shown are for illustration purposes only and may vary from the actual colour or finish. Unless specifically stated, all IP ratings nominated for Interior products are from "below the ceiling".

Dimensions

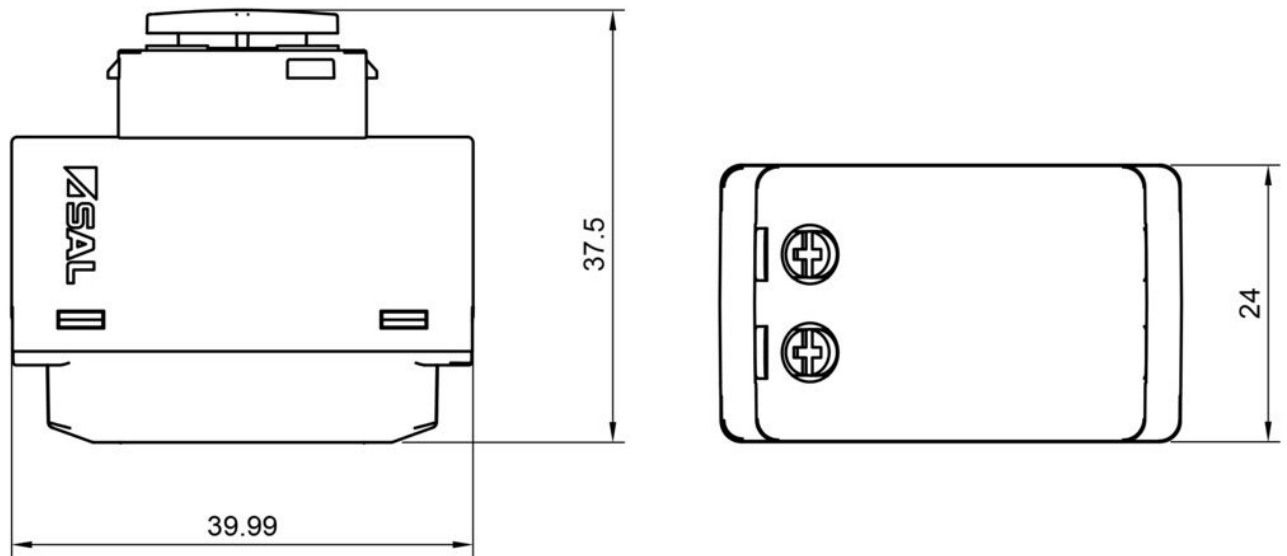

THE SFI SYSTEM ELIMINATES LED FLICKERING.

**SIMPLY
MATCH THE
ECOGEN SFI
DOWNLIGHT
WITH THIS
SDD400SFI
DIMMER.**



**DIM with
FLICKER
CONTROL**

For related
products
please
scan me

